

STANDARD DETAIL NOTES:

THIS IS A DIAGRAMMATIC REPRESENTATION AND CERTAIN DETAILS REMOVED FOR CLARITY.

IMPORTANT: ALL DIMENSIONS INDICATED ARE NOMINAL.

IMPORTANT:
THIS DATA IS RELEASED FOR
REFERENCE ONLY.

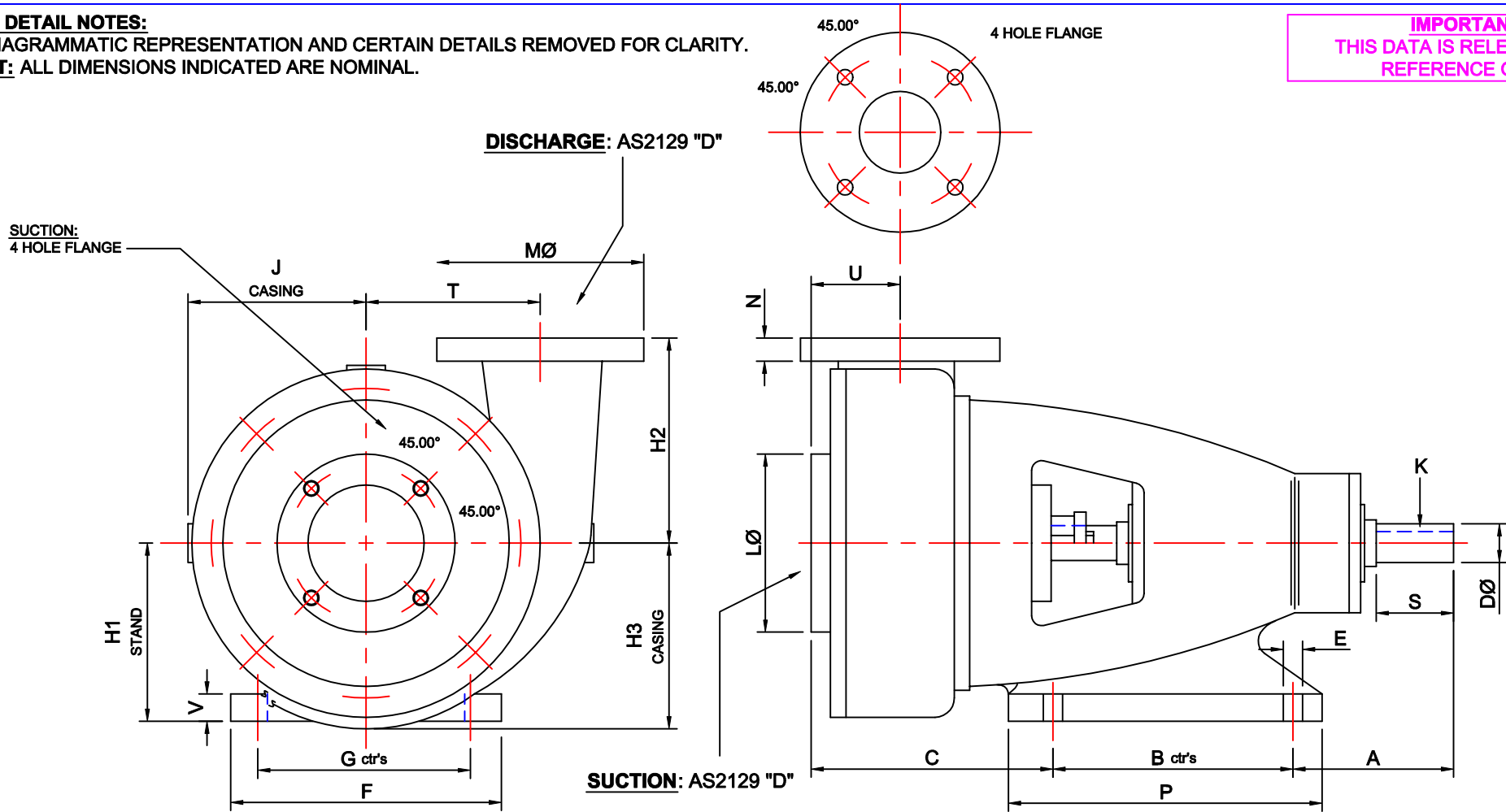

PUMP DIMENSIONS

PUMP SIZE	SUCT x DISCH	A	B	C	D	E	F	G	H1	H2	H3	J	K	L	M	N	P	S	T	U	V
80HL	100 x 80	152	203	180	1 1/4"	21	213	175	163	184	180	175	5/16"	222	184	22	276	64	175	65	36
509	AS 2129 "D"				inch								Sq inch								

REVISION	
----------	--

THIS DATA REMAINS THE PROPERTY OF STALKER ENGINEERING. NO DATA MAY BE REPRODUCED WITHOUT PRIOR CONSENT OF COMPANY. DATA MAY BE ALTERED WITHOUT NOTIFICATION.

AS1100 3rd ANGLE PROJECTION

DO NOT SCALE

GENERAL TOLERANCES
METRIC +/-0.400mm
IMPERIAL +/-0.015"

REFERENCE: ORIGINAL FILE REF.
12/07/2000 UPDATE 22/04/2003

APPRVD: CHECKED:

DRWN: AR

DATE: UPDATED
04/07/2003

SCALE:
DIAGRAMMATIC

FILE REF:
REFER DWG NUMBER



STALKER PUMPS
www.stalkerpumps.com.au

DIMENSION OUTLINE DIAGRAMMATIC
DC 5 SERIES STANDARD

DRAWING No: **5100DCDIMA3**

A3